

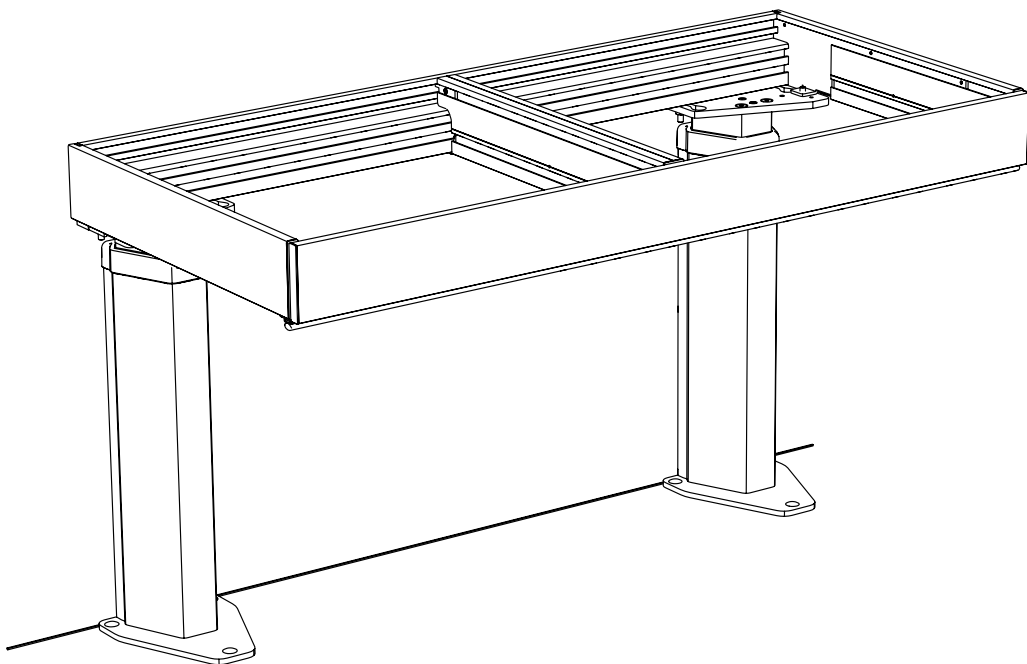

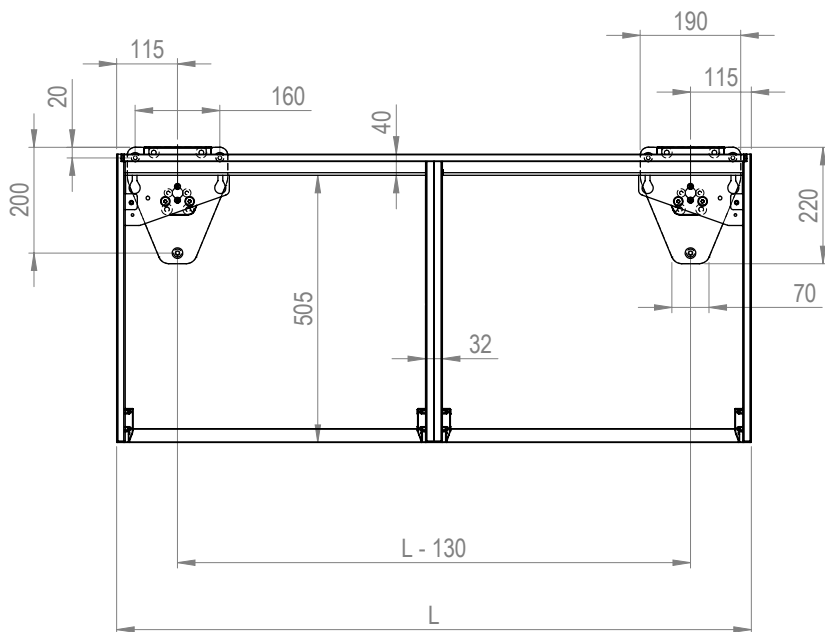

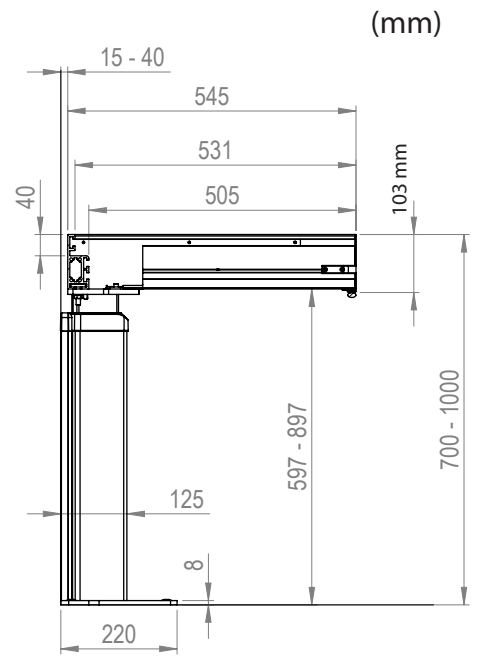

 **Installationsanvisning**
TR5 **Installation Instructions**
TR5

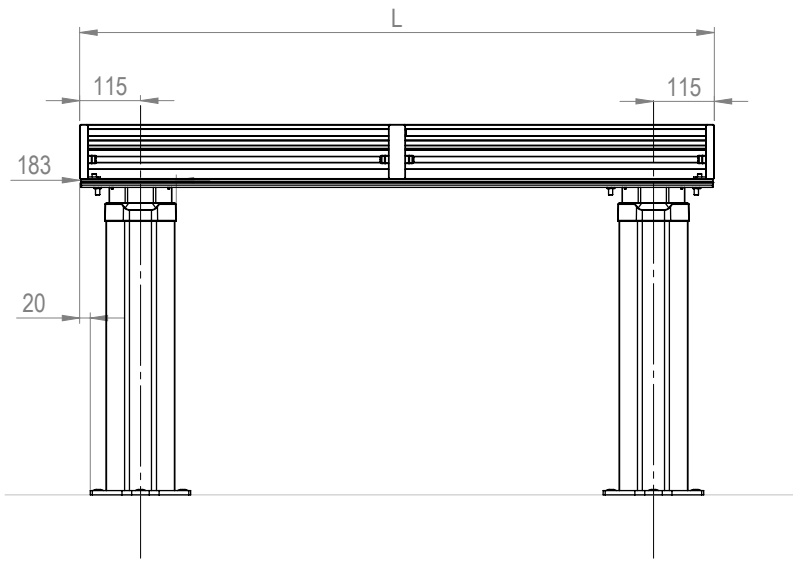

TR5	
	230/50Hz/5.0A
	20 mm / s
	300 mm
	100 kg
	6 / 1h

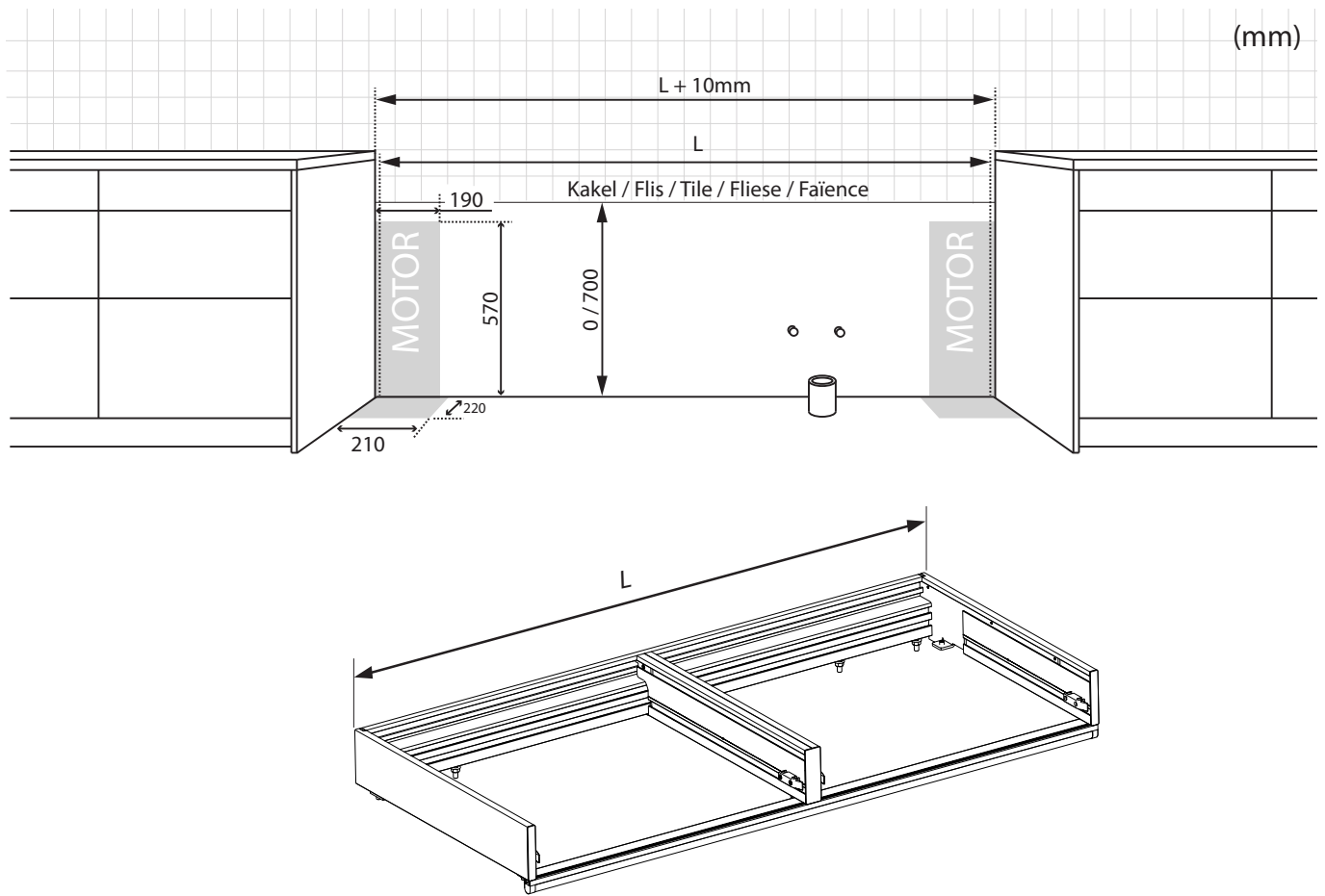

Vatten och avlopp / Water and Sewer

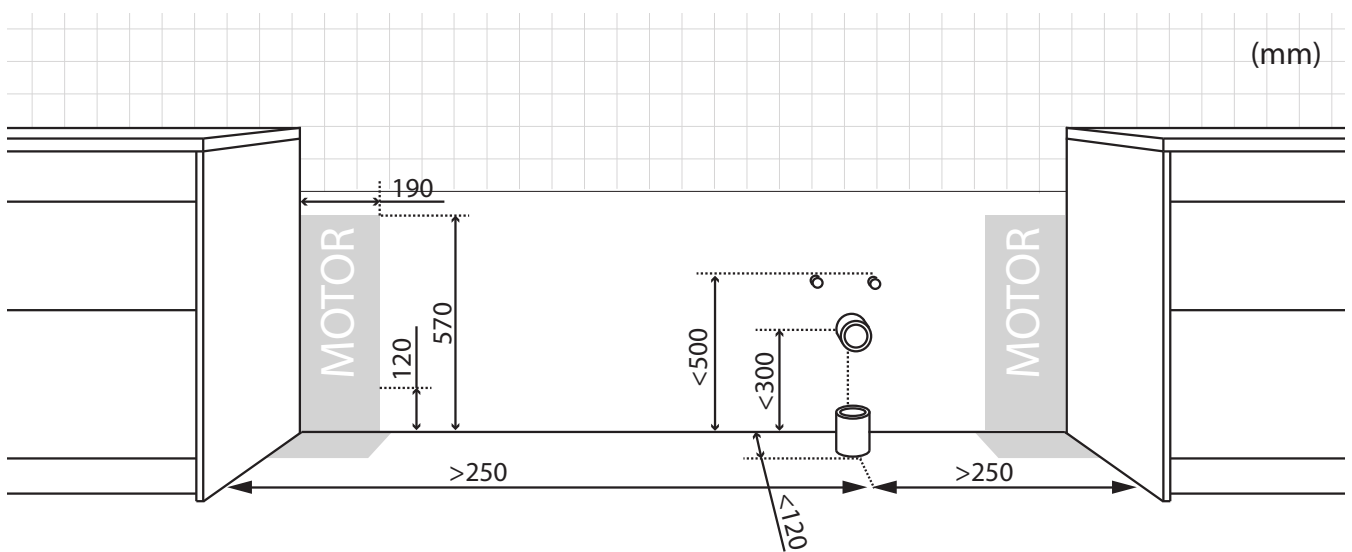

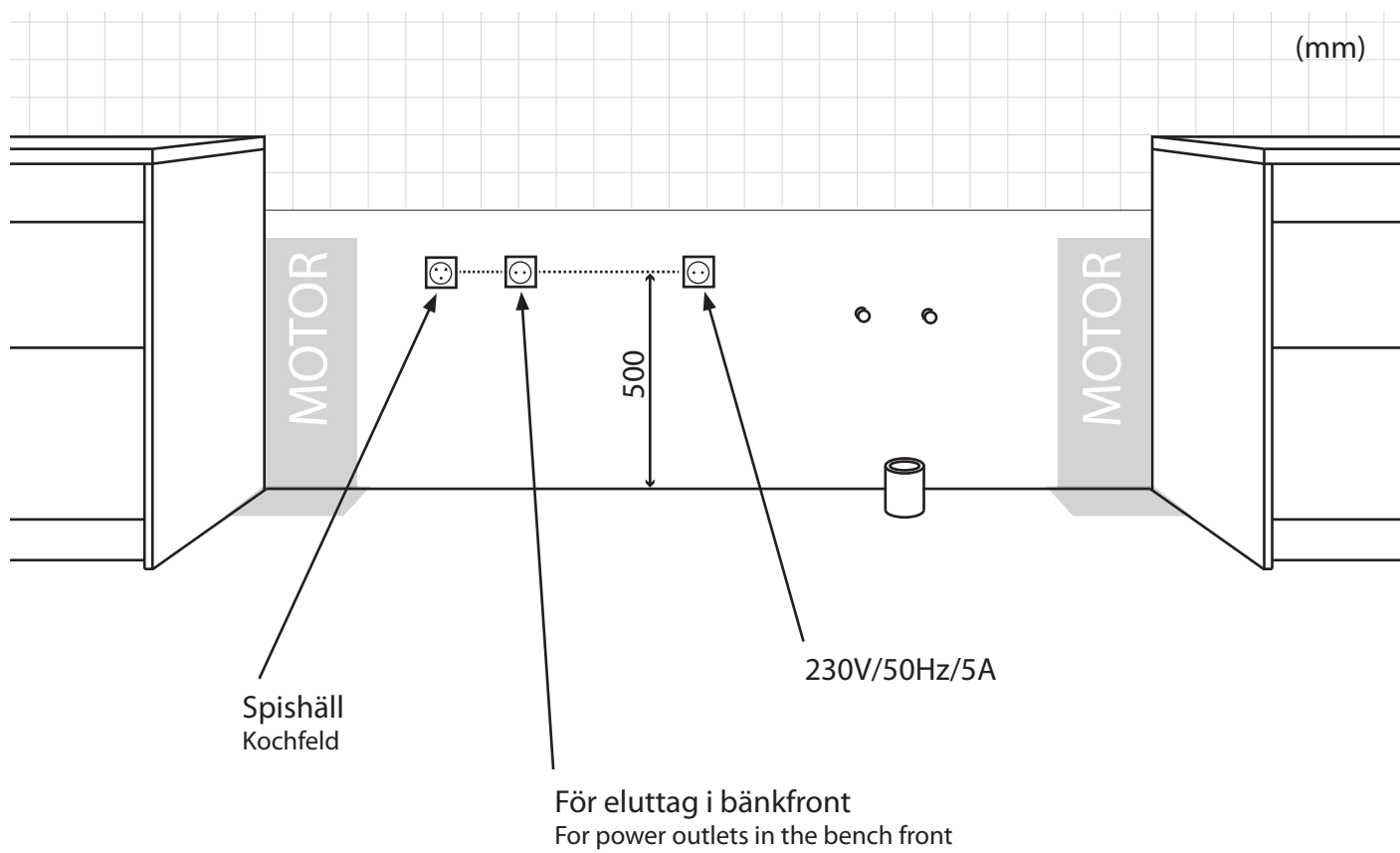

1

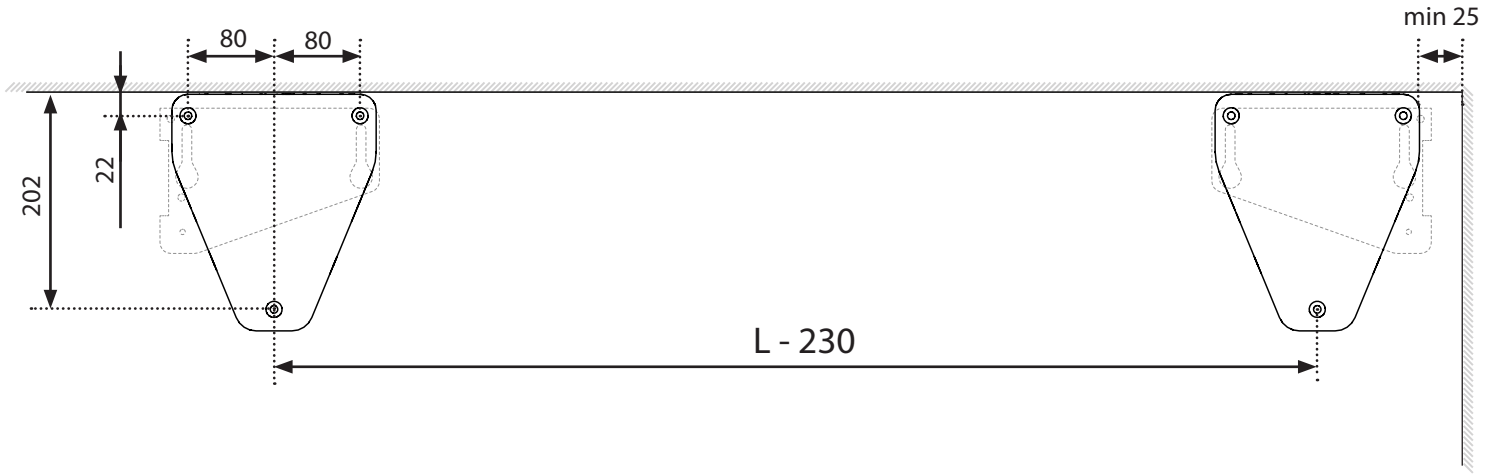
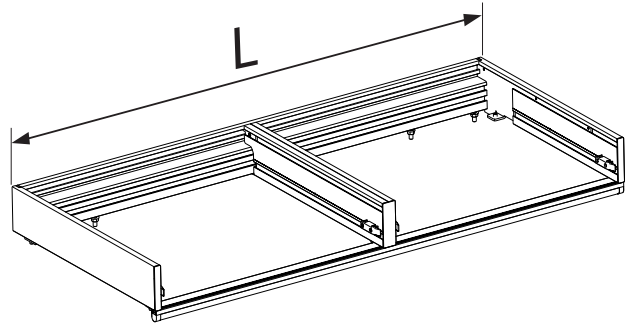

2

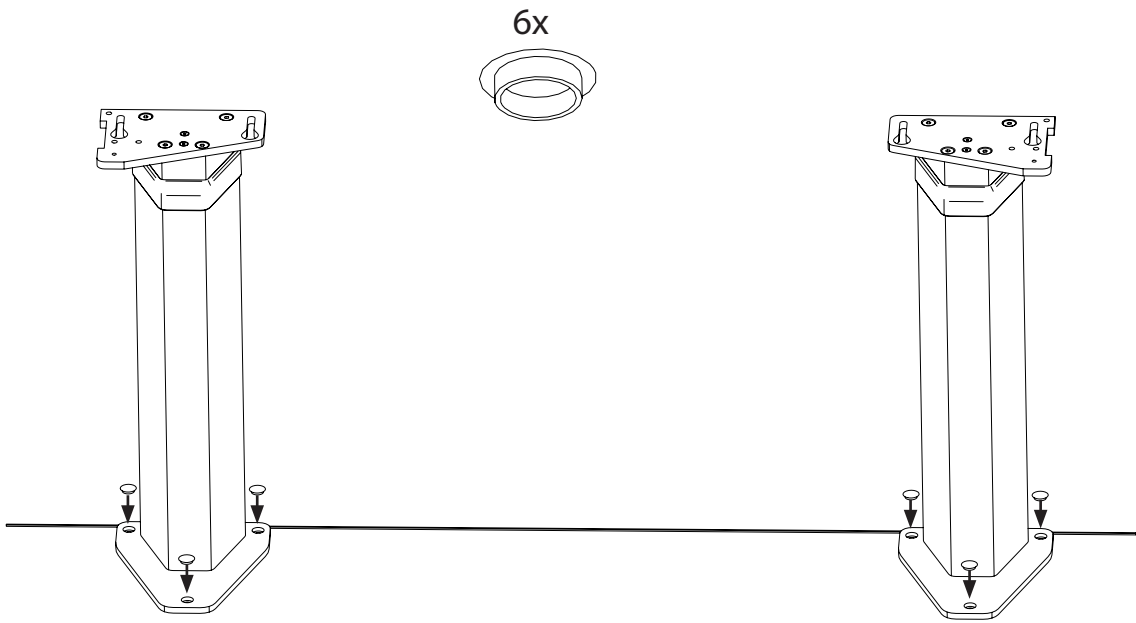

3

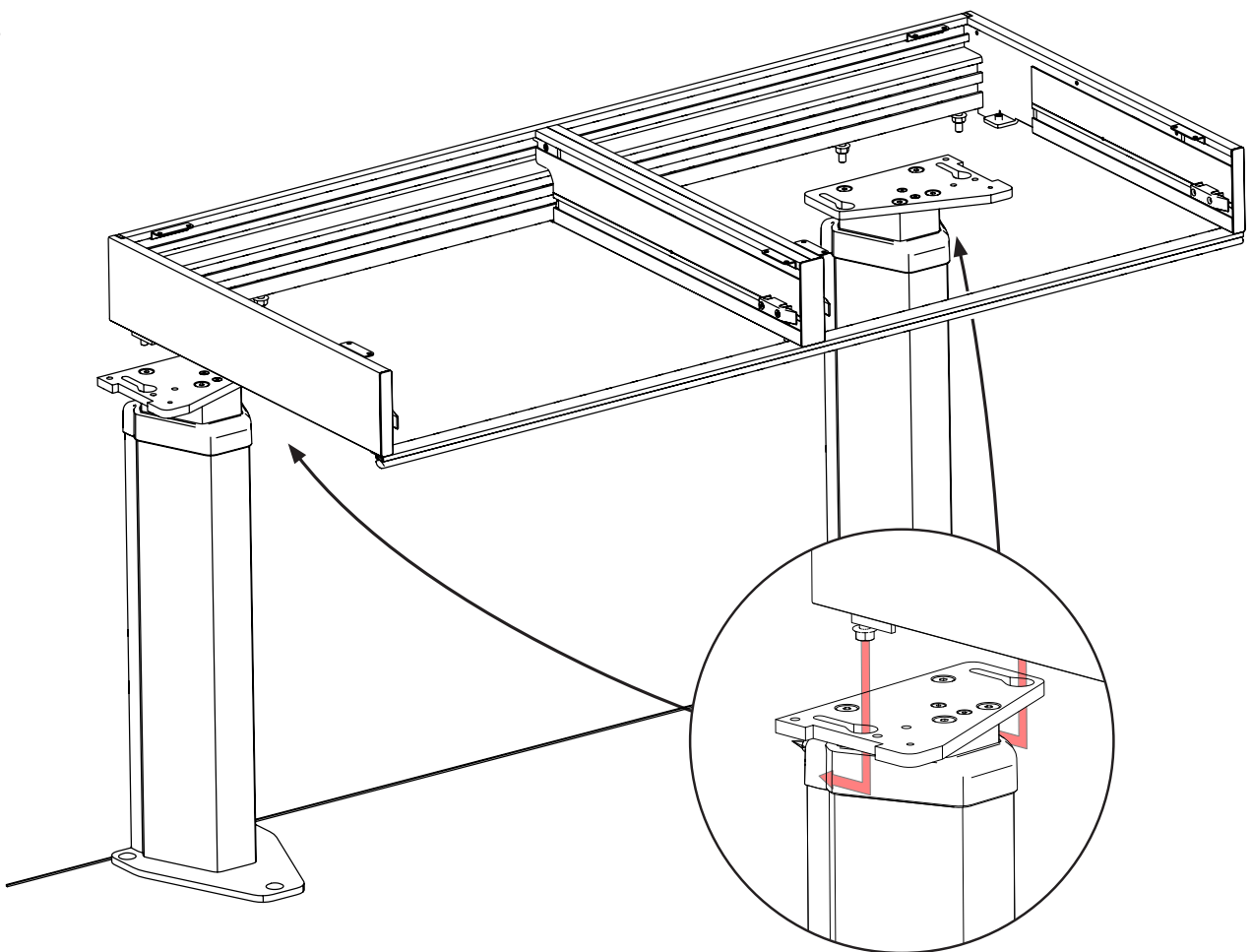

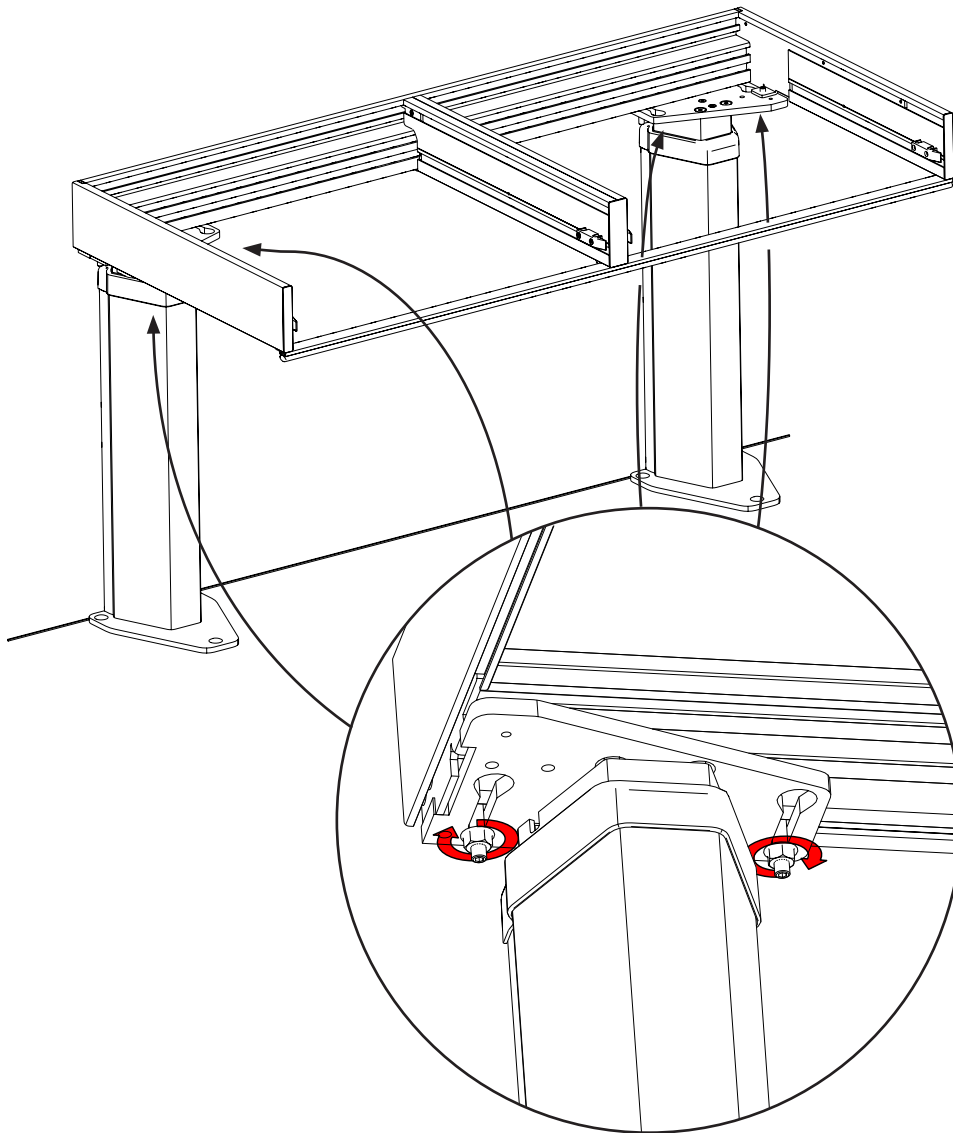
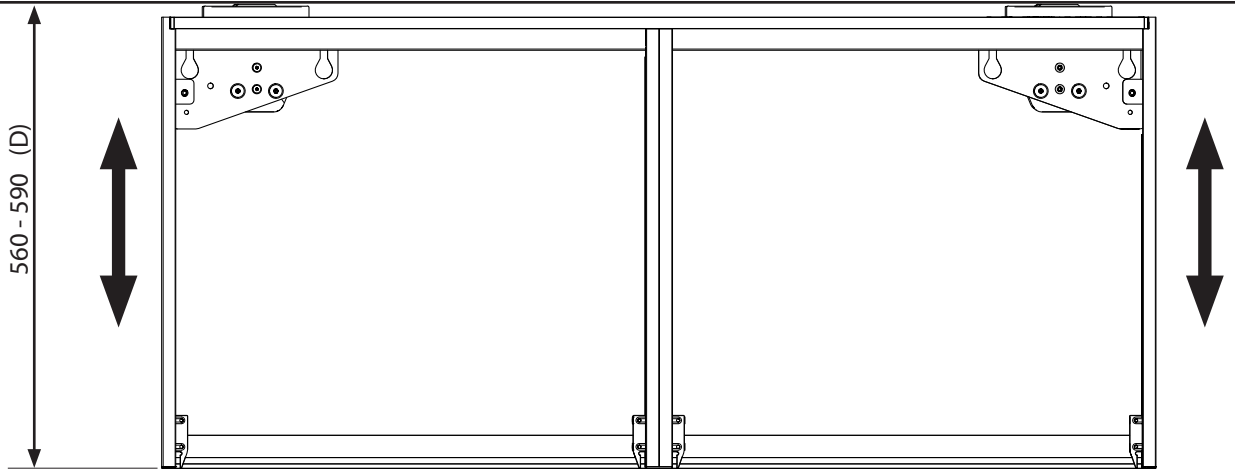

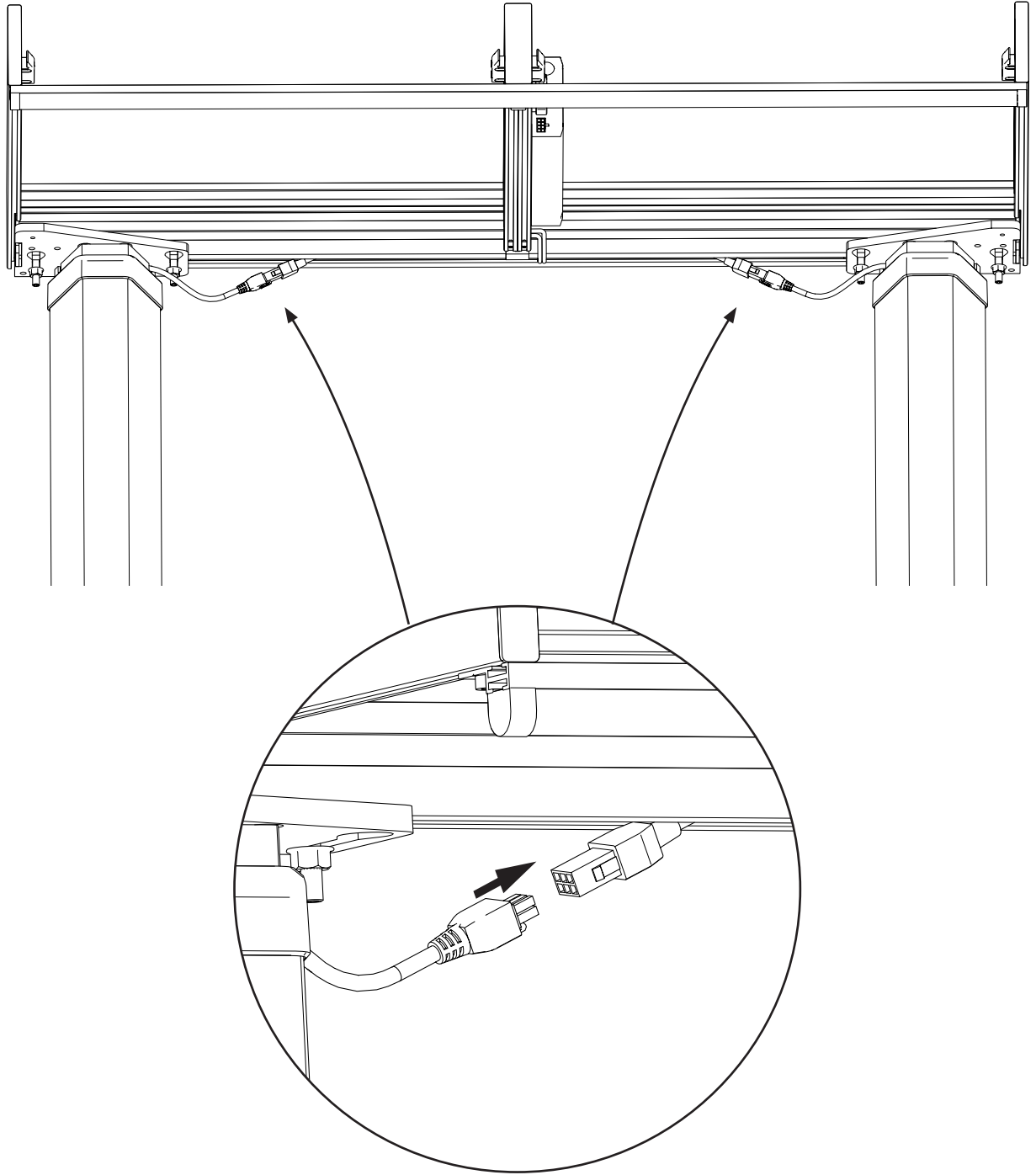

6

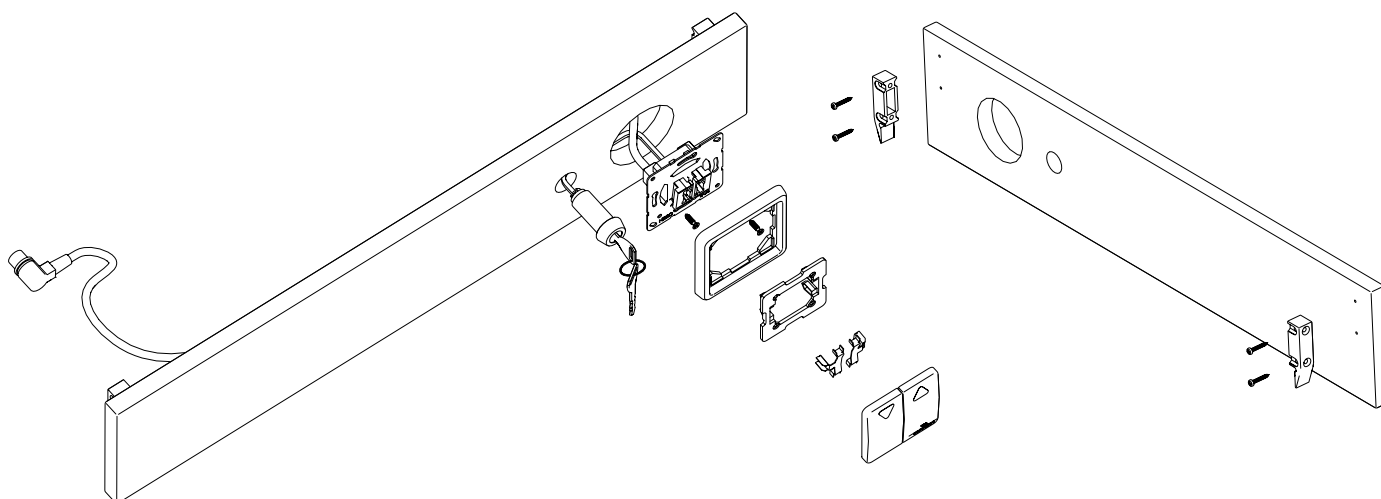
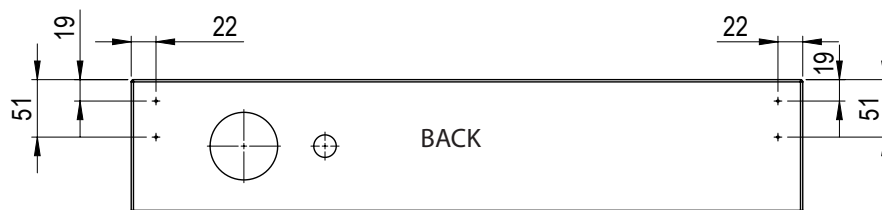
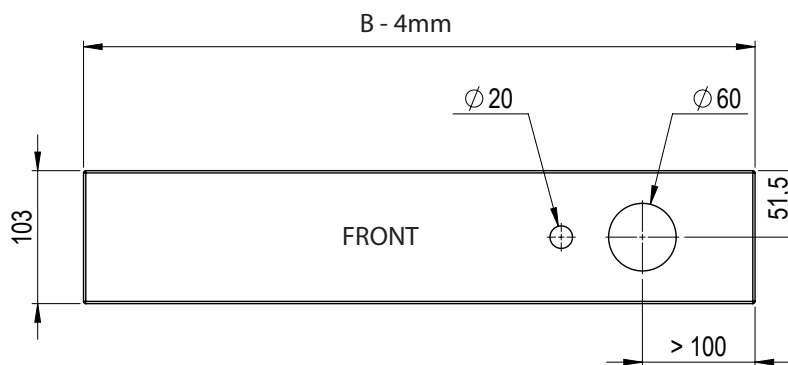
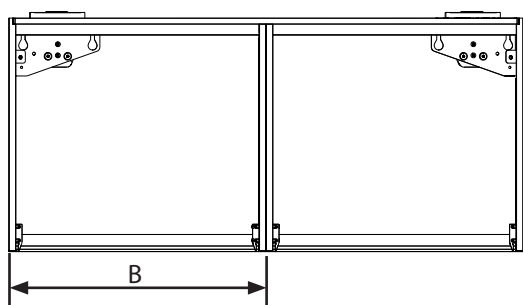
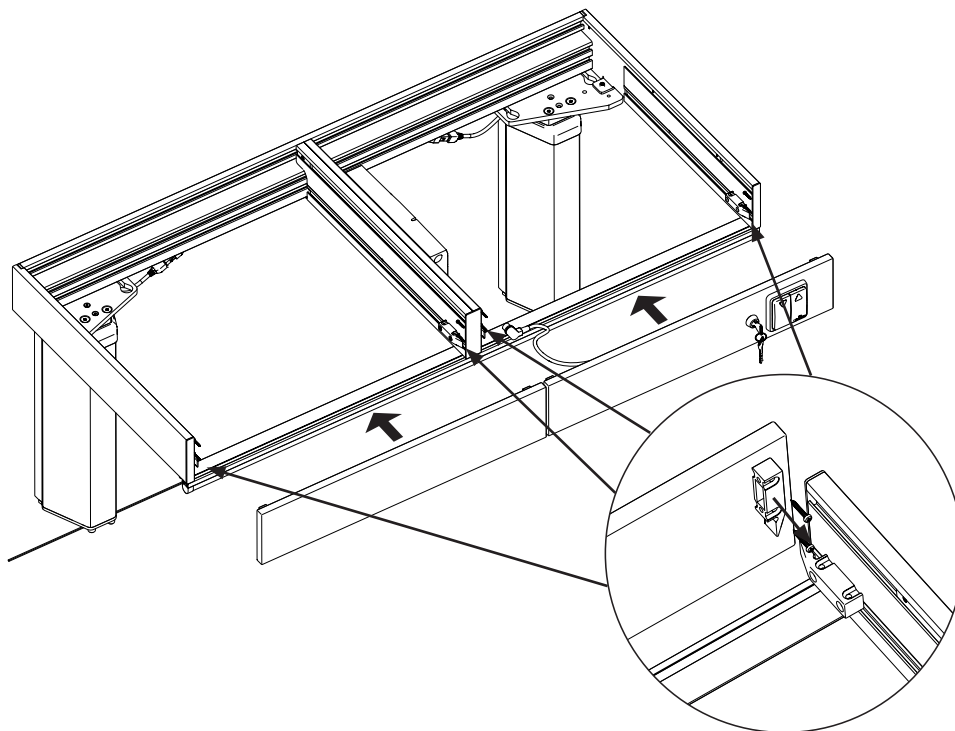

7

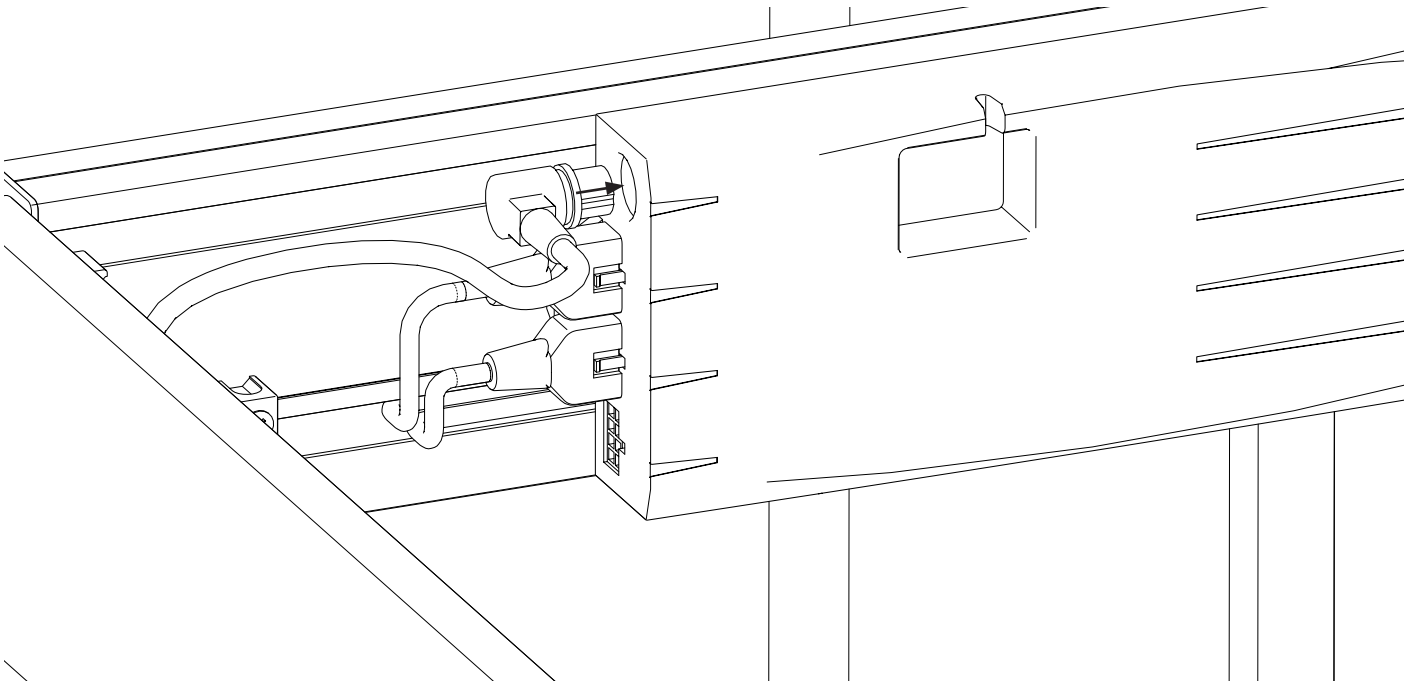

8

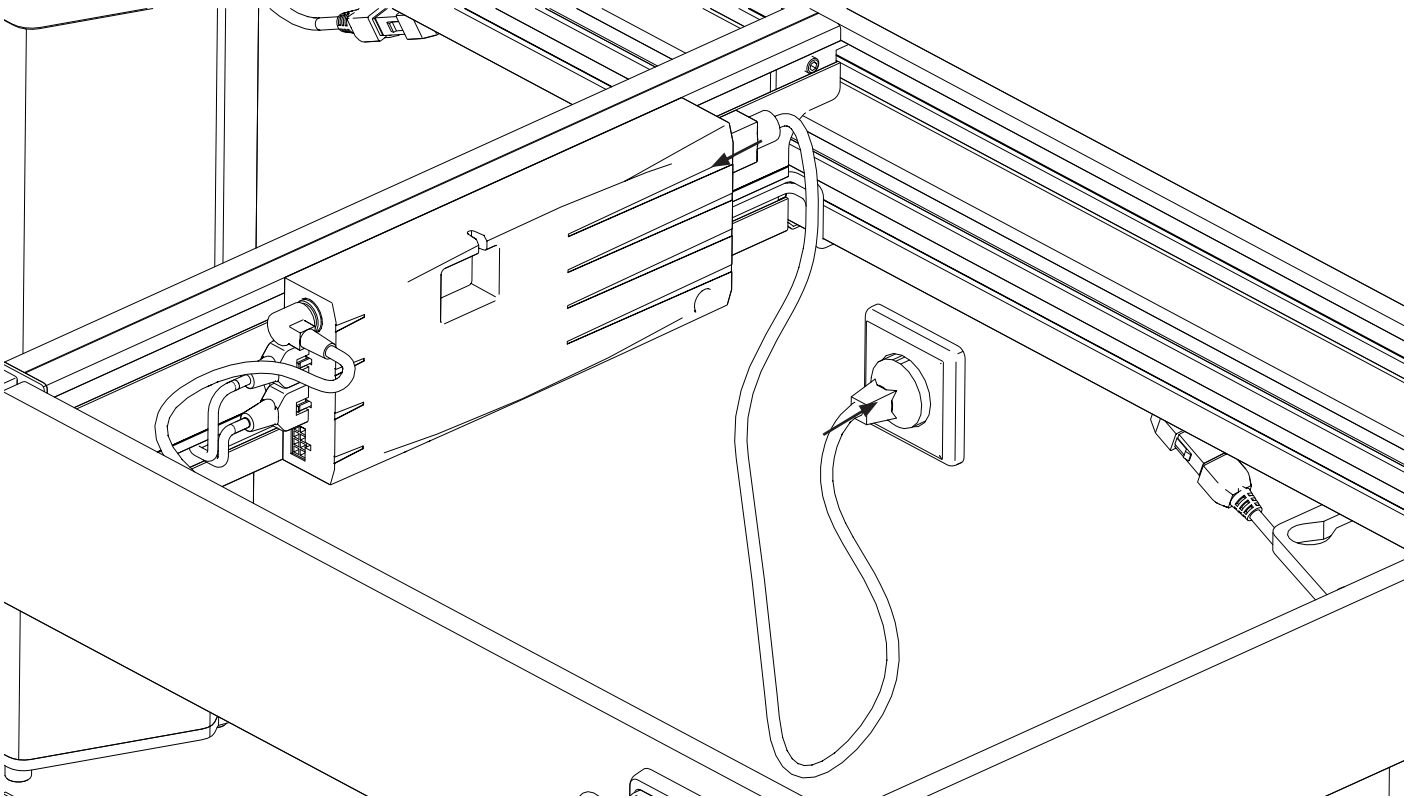

9

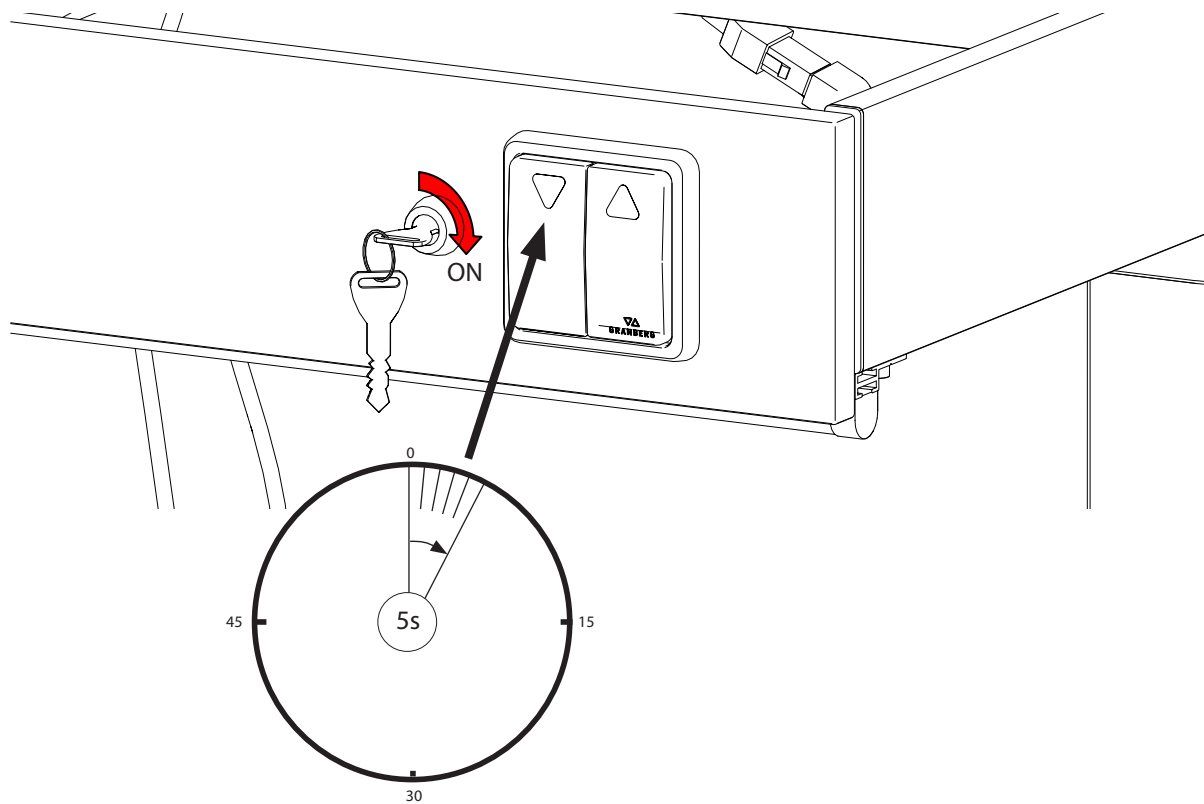

10

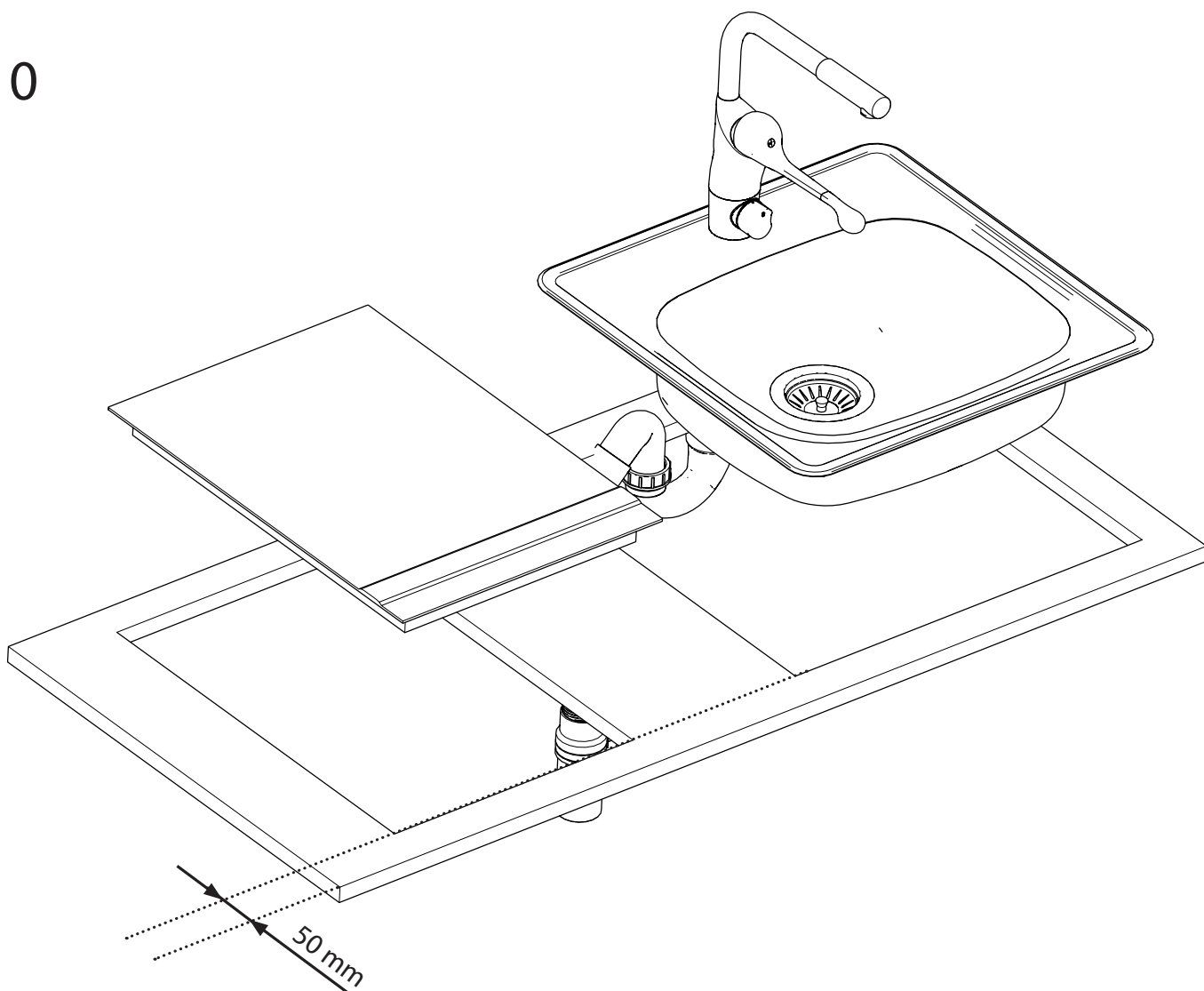

11

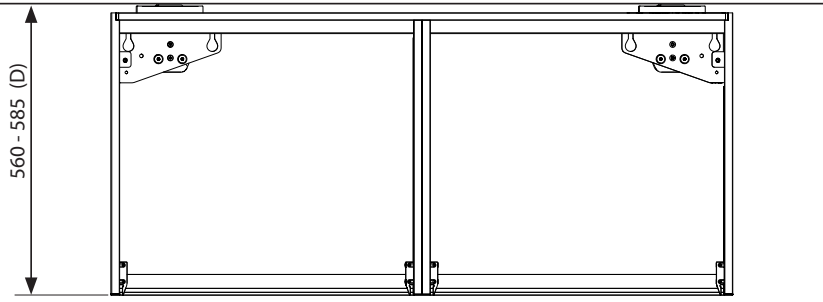

D	C
560	30
565	35
570	40
575	45
580	50
585	55

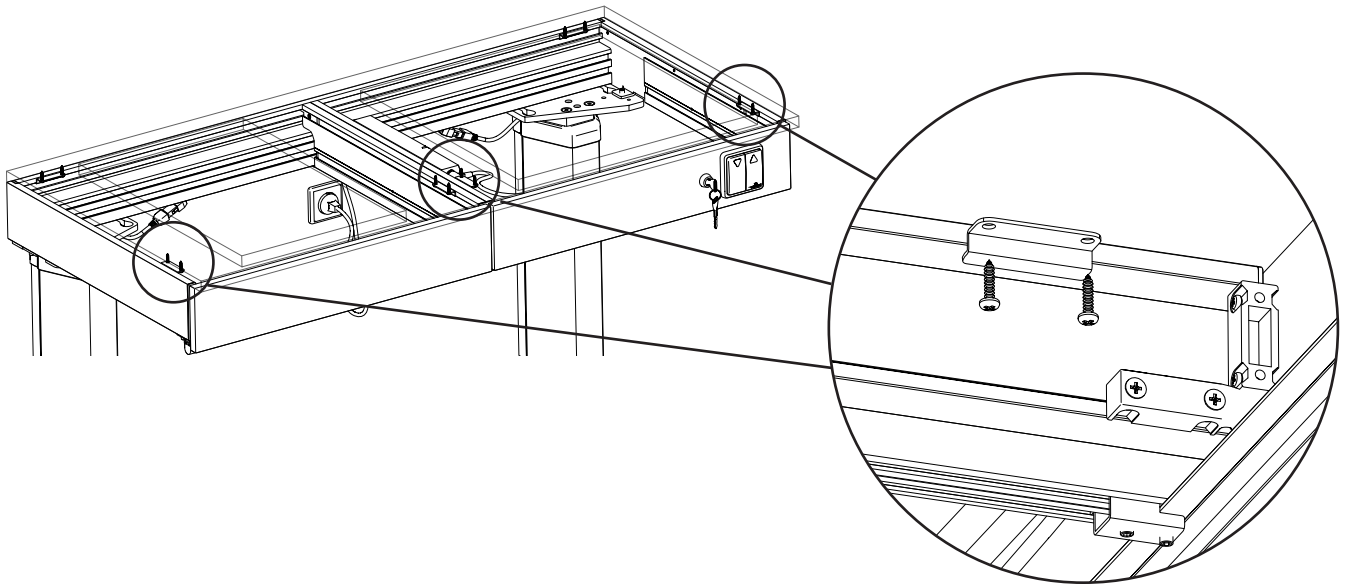
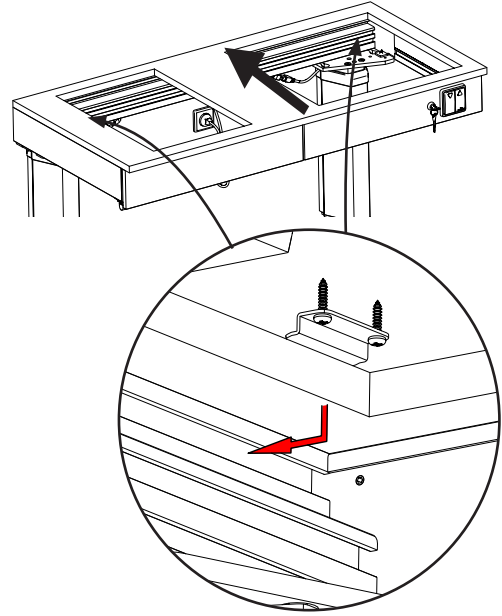
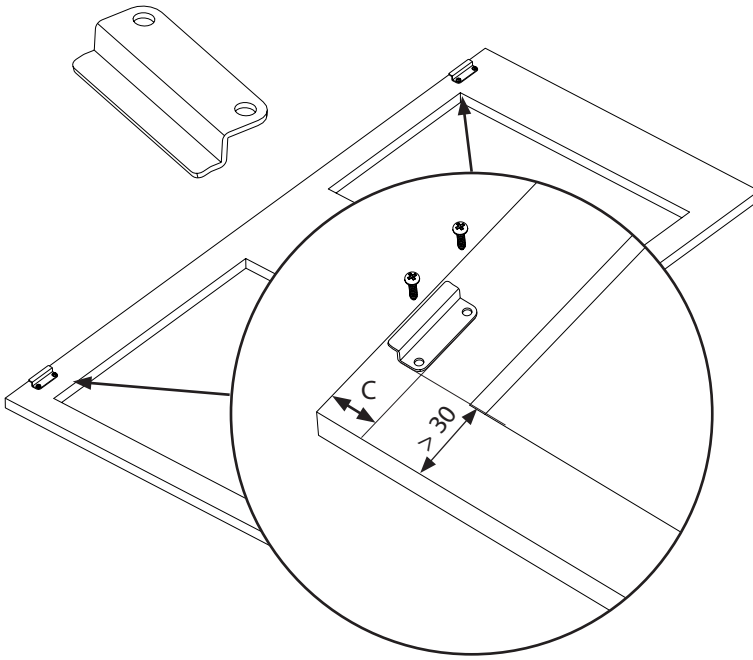

12

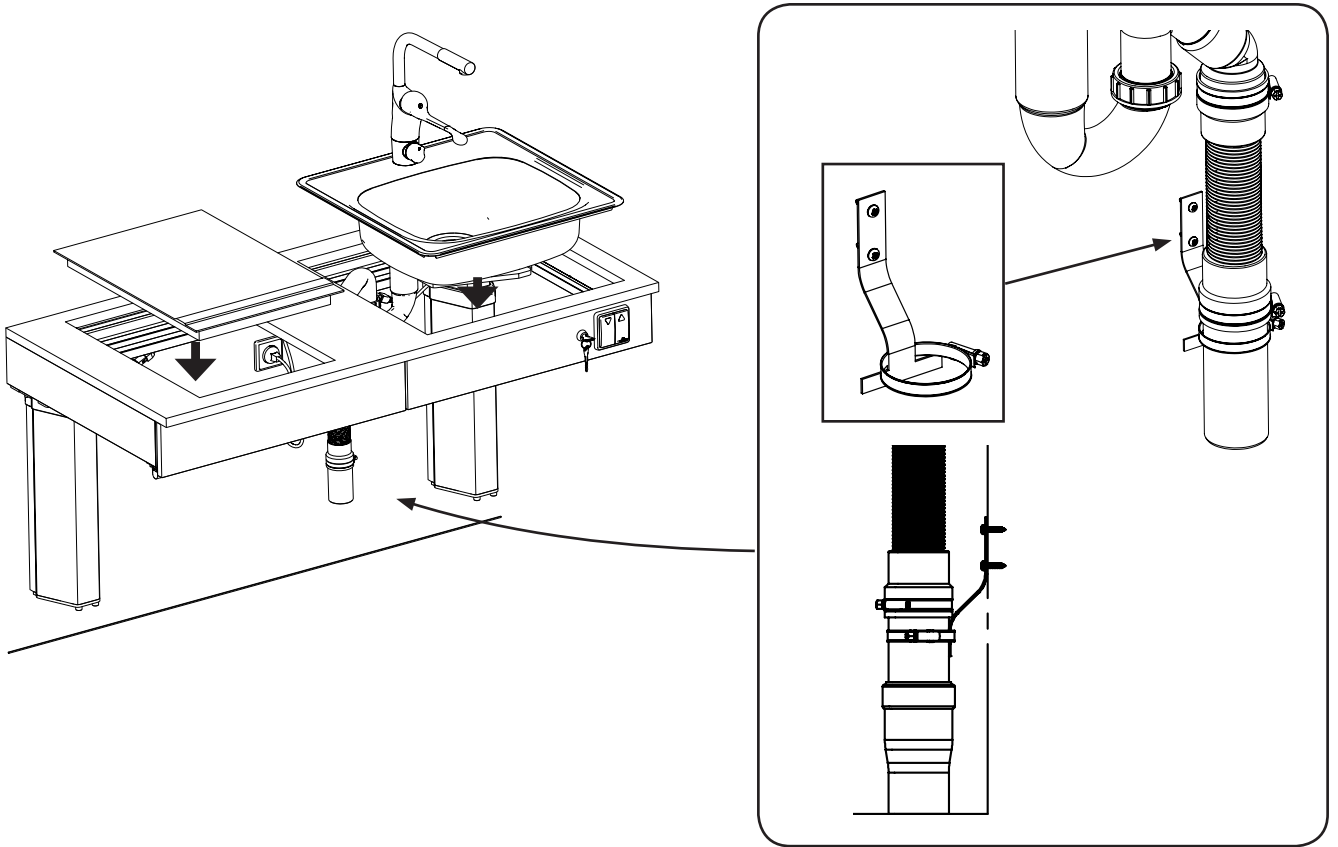

13

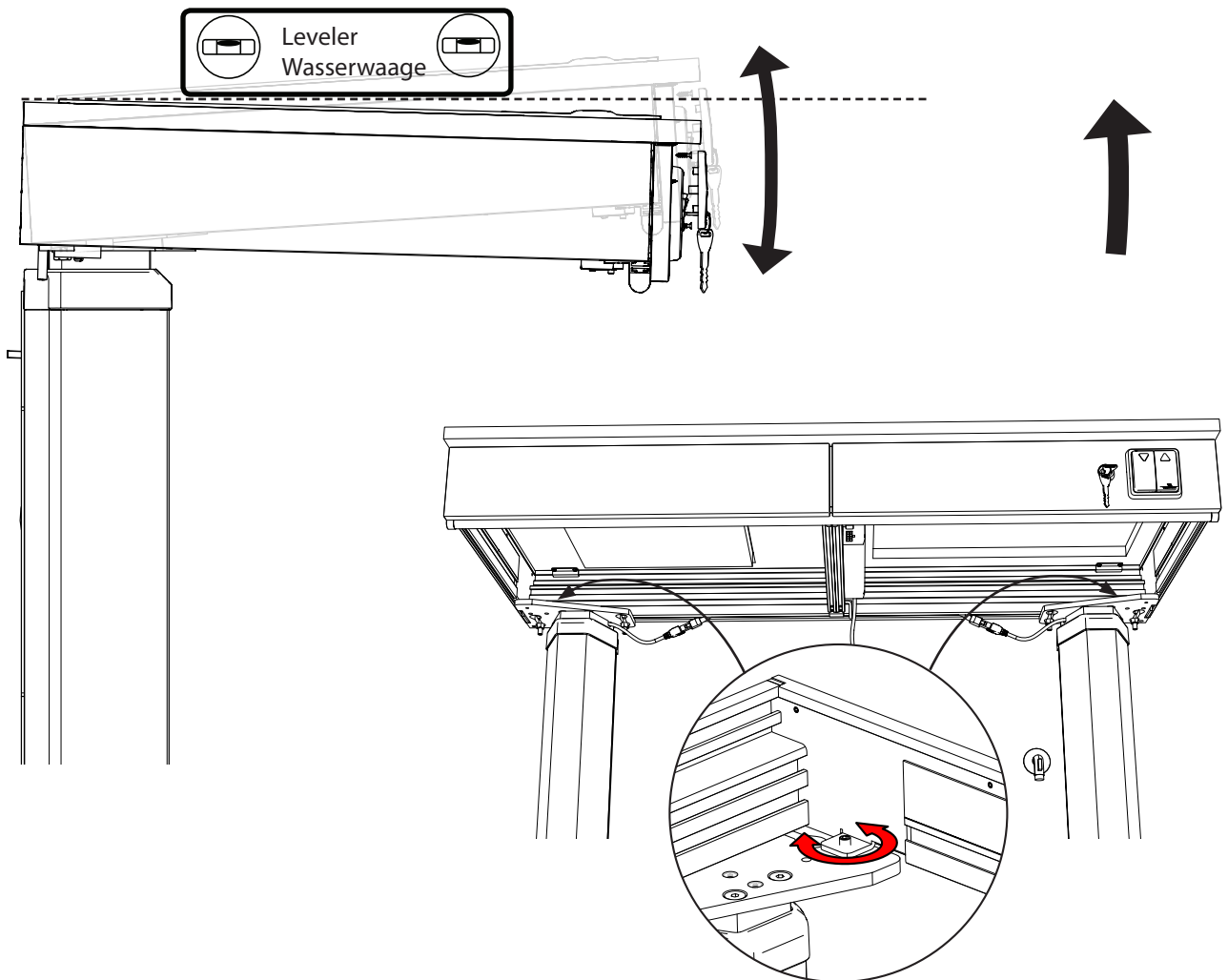

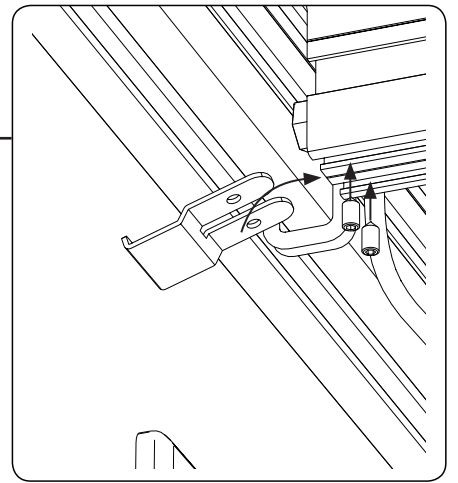
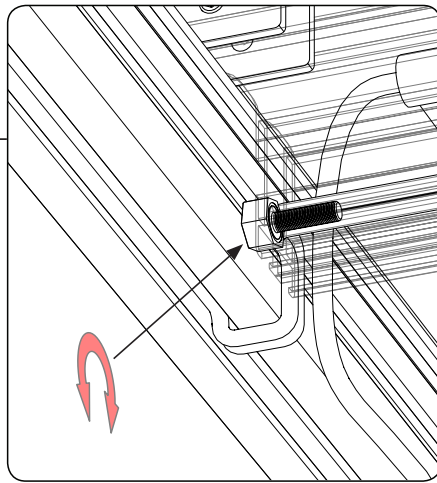
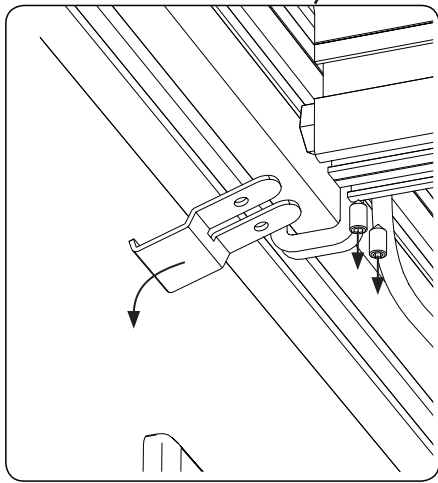
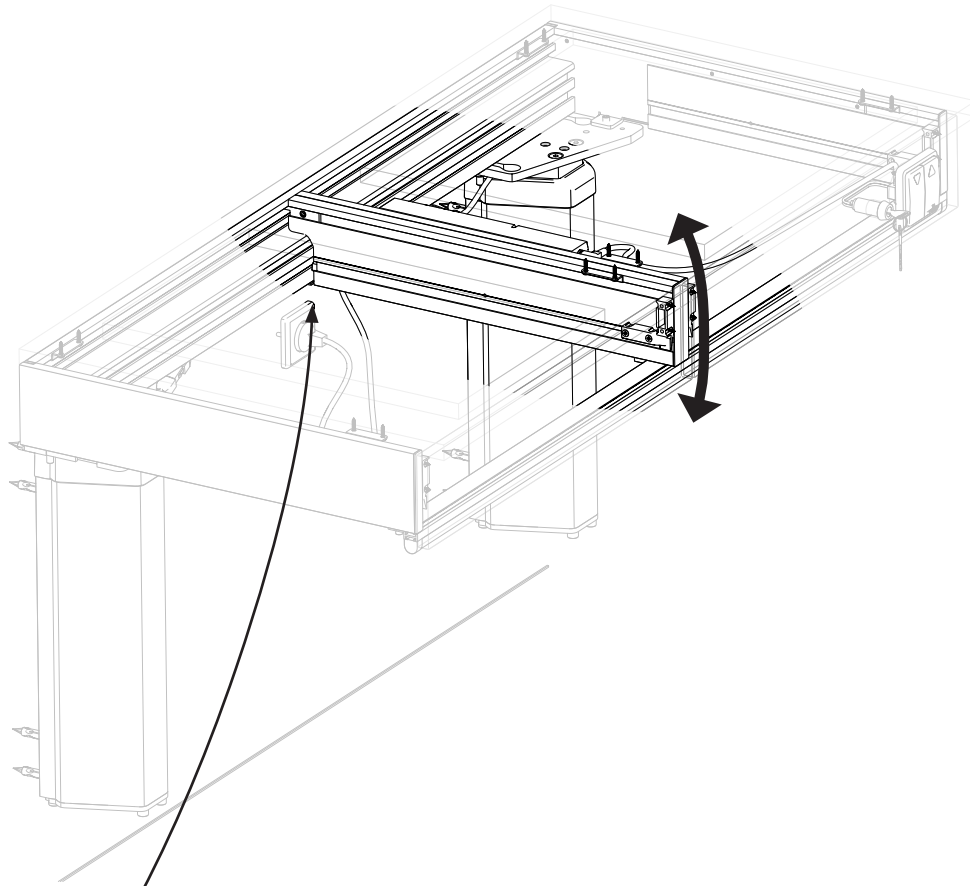

15

Tillbehör / Accessory

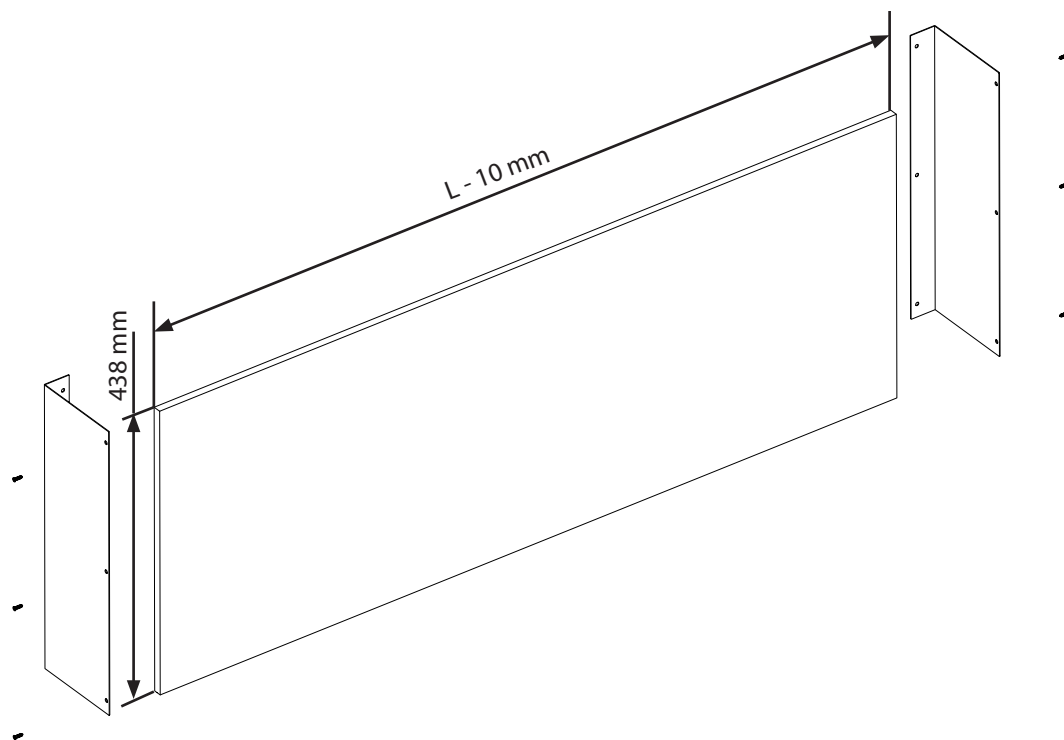

16

Tillbehör / Accessory

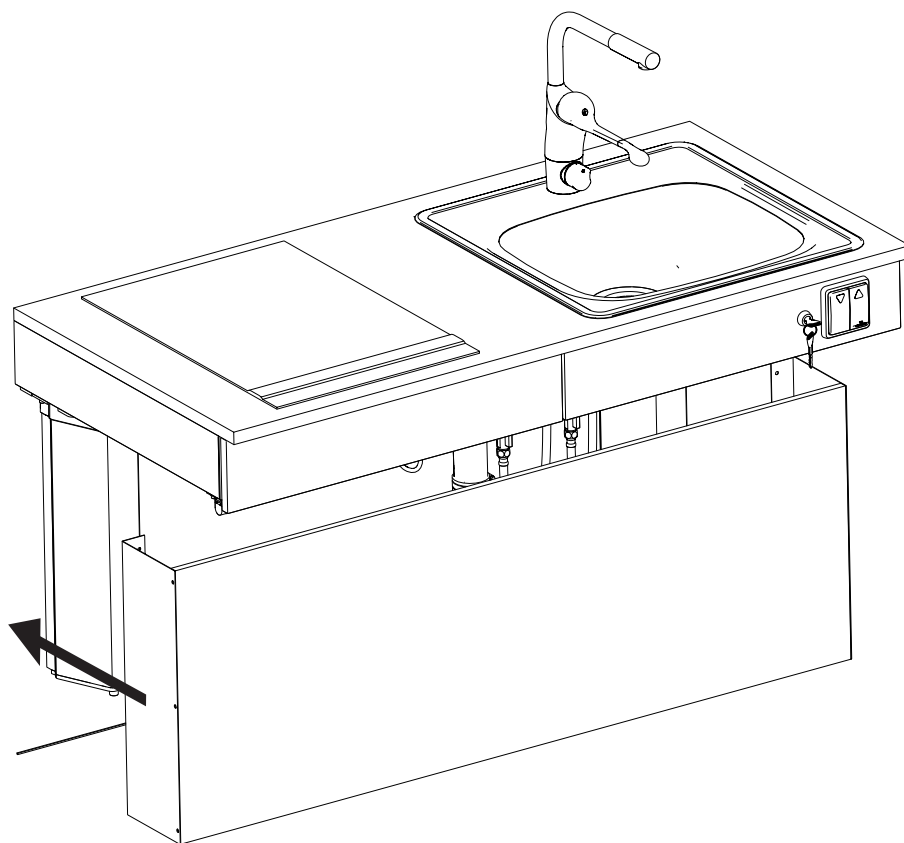

17

Tillbehör / Accessory

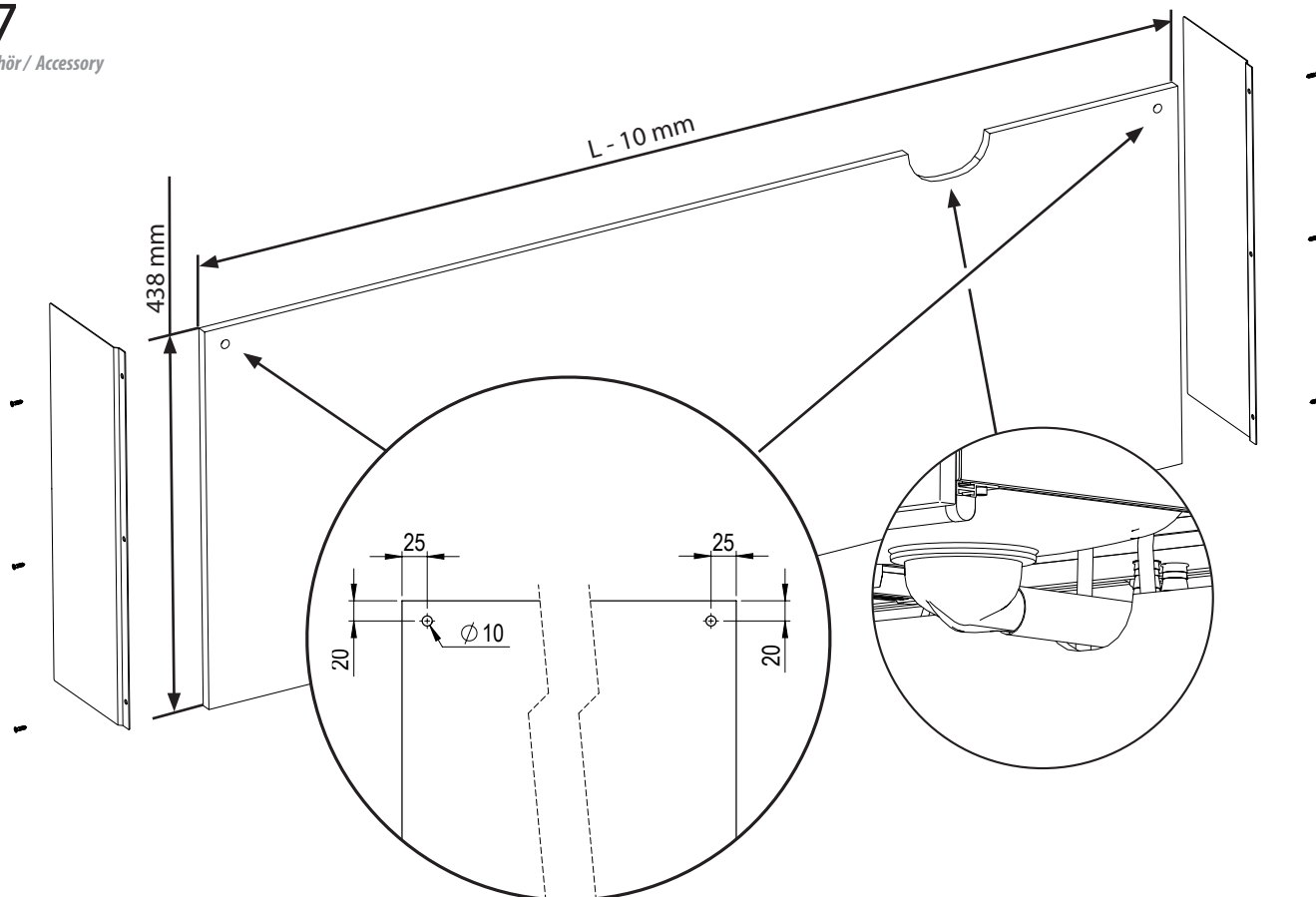

18

Tillbehör / Accessory

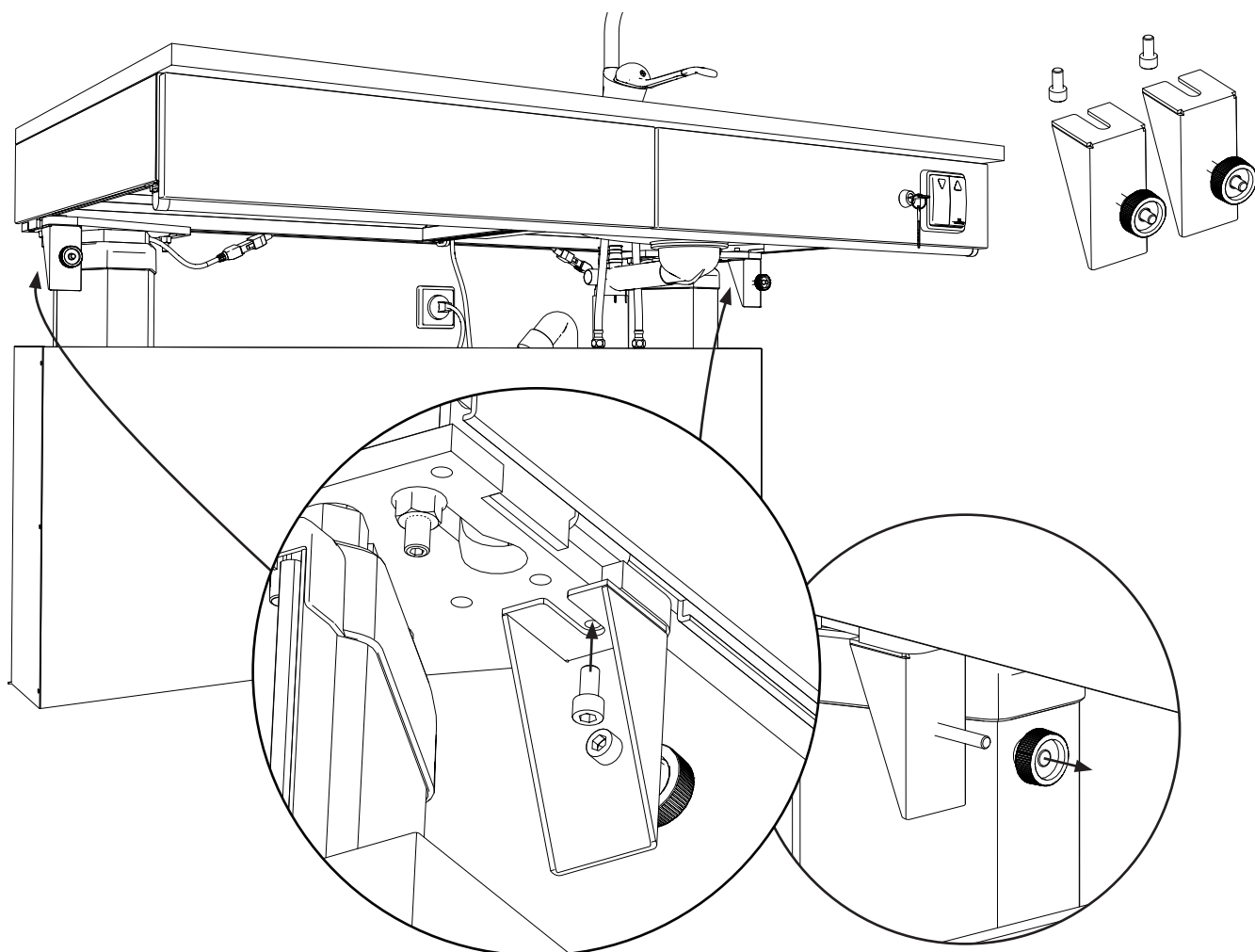

19

Tillbehör / Accessory

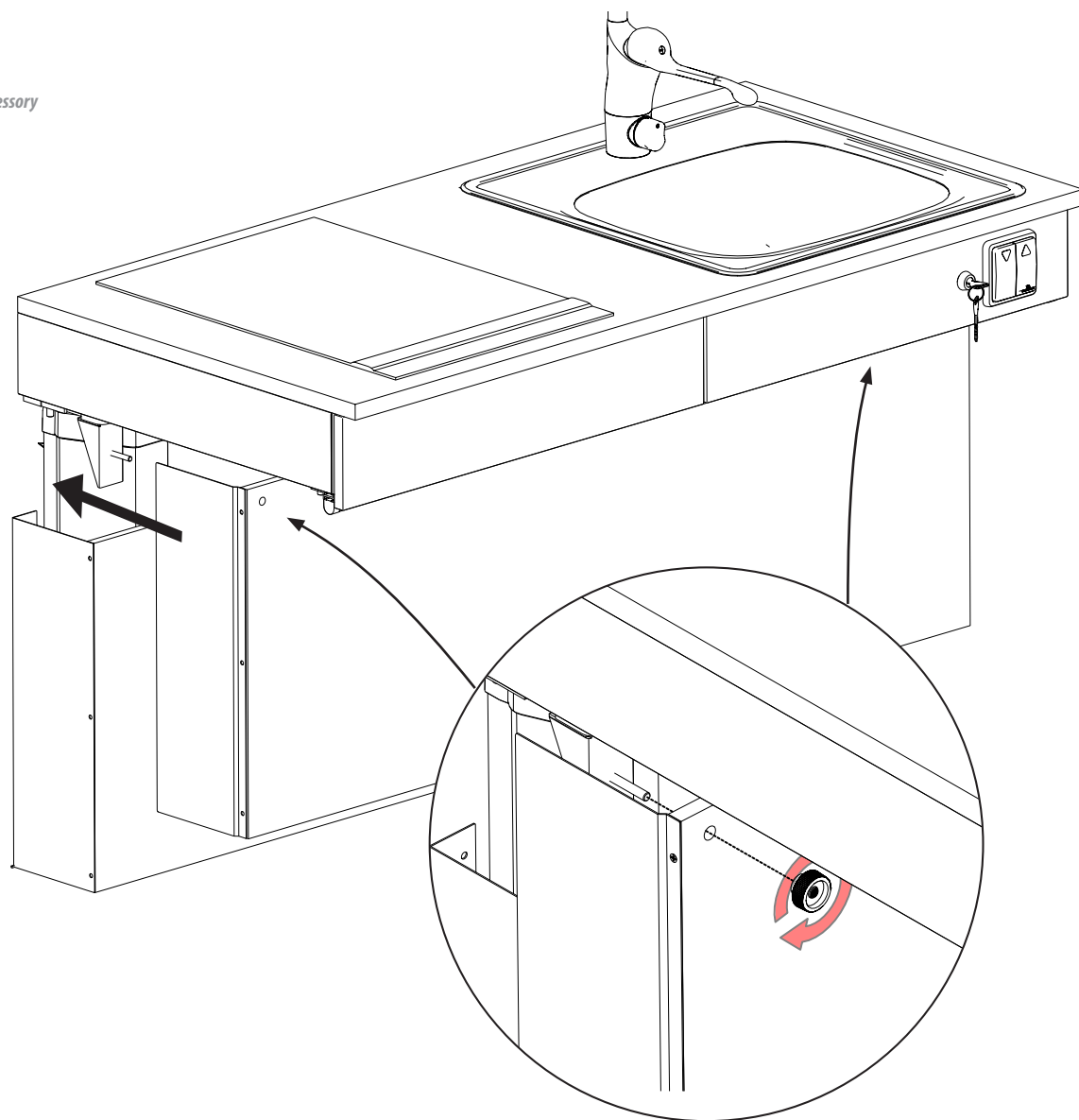

20

Tillbehör / Accessory

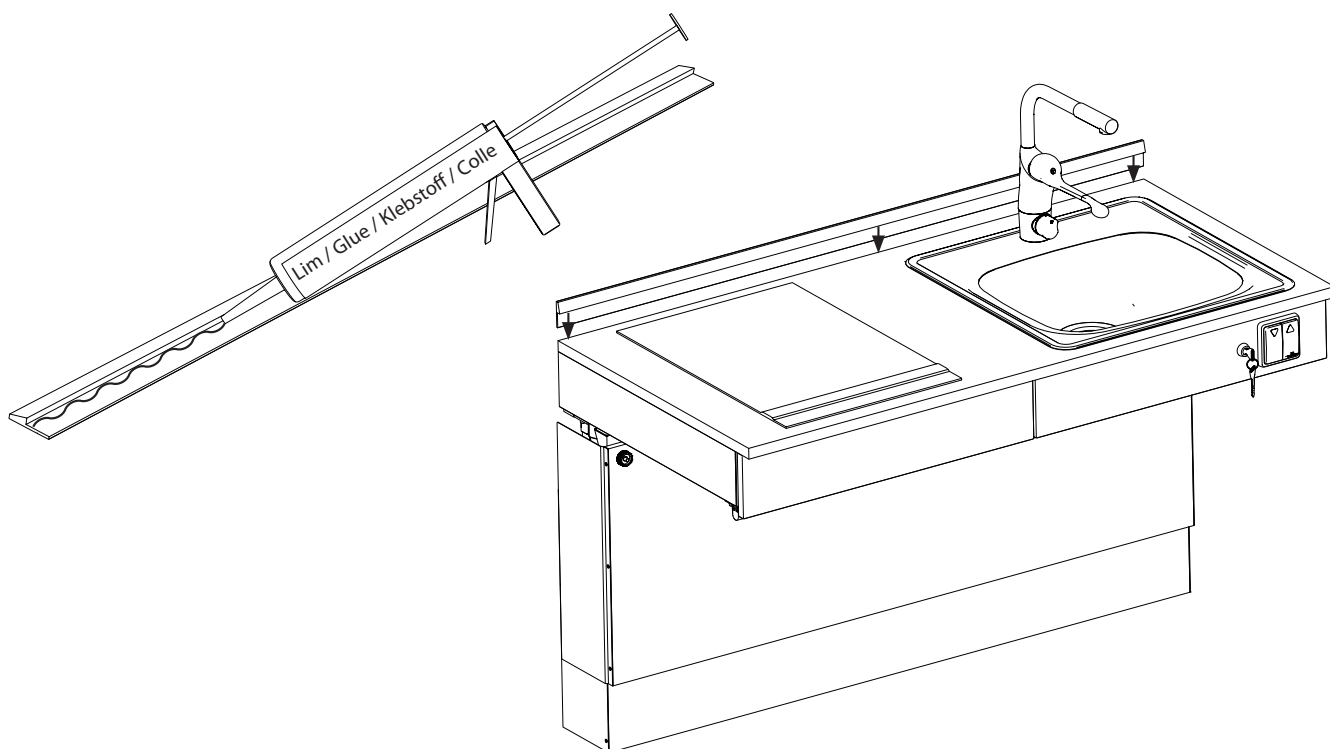

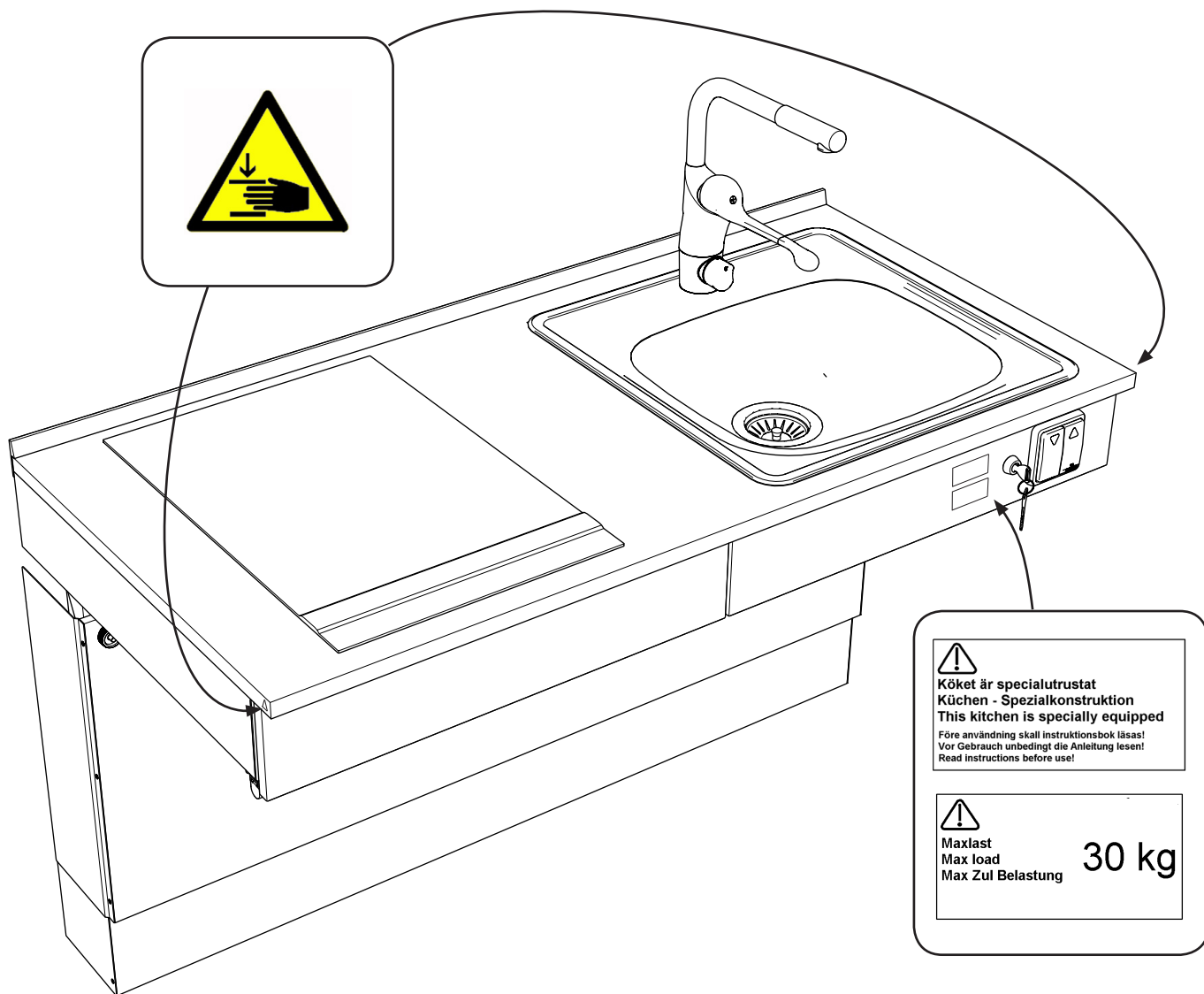

Köket är specialutrustat
Küchen - Spezialkonstruktion
This kitchen is specially equipped

Före användning skall instruktionsbok läsas!
Vor Gebrauch unbedingt die Anleitung lesen!
Read instructions before use!



Maxlast
Max load
Max Zul Belastung

30 kg

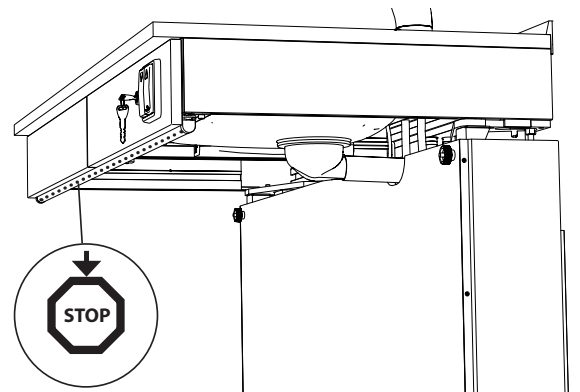
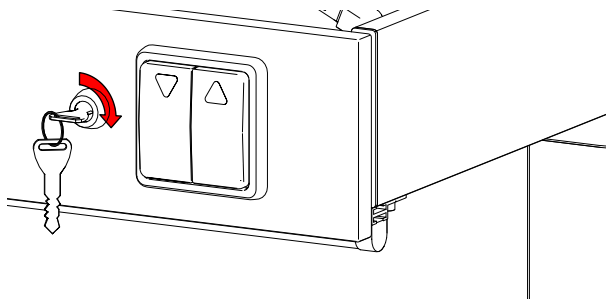

SE Funktionsprov

Efter installation ska komplett funktionsprov med full last genomföras:

- * Provkör bänklyftaren upp och ner hela vägen till respektive ändläge. Kontrollera att bänken löper fritt utan hinder, klämrisker och missljud. Kontrollera att den står kvar i nedre respektive övre läge.
- * Kontrollera att inga kablar eller slangar kommer i kläm och att de är fixerade.
- * Kör bänken nedåt och kontrollera att klämlisten under bänkens framkant fungerar genom att trycka lätt på den. Bänken ska stanna omedelbart och vända uppåt för att frigge utrymme.

EN Functional test

After installation a complete functional test with full load shall be made:

- * Run the worktop lift unit down and up all the way to respectively end position and make the following checks:
Check that it moves freely, without hindrance and jarring sounds.
Check that it stays in the lowest resp. top positions.
- * Check that no cables or hoses are jammed and that they are fixed.
- * Lower the worktop lift unit and check that the security strip under the aluminium frame works properly, by means of pressing lightly onto it. The worktop lift shall stop immediately.

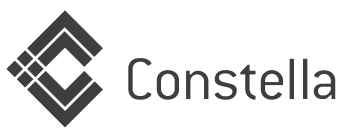

Constella Försäljning AB
Box 10024 781 10 Borlänge
Tel: 0243-83140
E-mail: info@constella.se
Internet: www.constella.se

